

220-240V 50 1~



### GENERAL DATA

**Application:** HBP  
**Refrigerant:** R134a  
**Evaporating Temperature Range:** -15°C to 10°C  
**Compressor Cooling:** Fan  
**Fan air flow:** 800 m<sup>3</sup>/h  
**Type:** Hermetic reciprocating  
**Technology Type:** On-Off  
**Expansion Device:** Capillary Tube or Expansion Valve  
**Packing Quantity:** Multi - 36 pcs  
**Displacement:** 34.4 cm<sup>3</sup>  
**Horse power:** 1 hp

Approvals:     



### MECHANICAL DATA

**Bore:** 42.85 mm  
**Stroke:** 23.85 mm  
**Oil Charge:** 750ml +/-15ml  
**Free Internal Volume:** 3.9 cm<sup>3</sup>  
**Maximum Recommended Refrigerant Charge:** 800 g  
**Oil Type Configuration:** Polyolester  
**Oil Type Viscosity:** ISO22  
**Compressor pressurization:** Dry air charge  
**Weight:** 20.5 kg

### ELECTRICAL DATA

**Motor Type:** CSR  
**Starting Torque:** HST  
**Voltage working range at 50 Hz:** 198-254 V  
**Maximum Motor Temperature:** 130 °C  
**Start Winding Resistance:** 8.7 Ω (± 10%) at 25°C  
**Run Winding Resistance:** 2 Ω (± 10%) at 25°C

### MOUNTING ACCESSORIES

	Description	Code
<b>Cover:</b>	yes	2075281
<b>Terminal Board:</b>	no	-
<b>Anchorage:</b>	no	-
<b>Overload Protector Bracket:</b>	no	-
<b>Capacitor Bracket:</b>	no	-
<b>Grommets:</b>	yes	2221004
<b>Sleeves:</b>	yes	2222016
<b>Washer:</b>	no	-
<b>Pin:</b>	no	-
<b>Clip:</b>	no	-
<b>Rotolock valve:</b>	no	-

### ELECTRICAL COMPONENTS

	Component type	Description	Code
<b>Starting Device:</b>	Potential relay	RVA4M3C-109	1253012
<b>Motor Protection:</b>	External 3/4"	T0335/C9	2289022
<b>Start Capacitor:</b>		72-88 MFD 330V	2252270
<b>Run Capacitor:</b>		17.5 MFD	2253311
<b>CSR / CSIR Box:</b>	yes		1262273

### EXTERNAL CHARACTERISTICS

**Base Plate:** Large  
**Tray Holder:** No  
**Height:** 253 mm

	Internal Diameter (mm)	Material	Shape
<b>Suction Connector</b>	12.77	Copper	Vertical
<b>Discharge Connector</b>	8	Copper	Slanted 65°

## RATED POINT DATA

Cooling Capacity (W)	Power Consumption (W)	Current Consumption (A)	Gas Flow Rate (kg/h)	Efficiency (W/W)
±5%	±5%	±5%	±5%	±7%
2 607	1 153	5.50	65.41	2.26

Test condition: EN 12900, Fan, Return Gas 20°C, Subcooling OK, Evaporating: 5°C, Condensing: 50°C, Ambient: 35°C

## PERFORMANCE CURVE DATA

**220V 50Hz**

Condensing Temperature (°C)	Evaporating Temperature (°C)	Cooling Capacity (W)	Power Consumption (W)	Current Consumption (A)	Gas Flow Rate (kg/h)	Efficiency (W/W)
		±5%	±5%	±5%	±5%	±7%
<b>35°C</b>	10	4 003	1 101	5.17	87.54	3.64
	5	3 345	1 009	4.86	72.48	3.32
	0	2 770	927	4.56	59.57	2.99
	-5	2 267	851	4.26	48.47	2.66
	-10	1 825	776	3.97	38.83	2.35
	-15	1 433	697	3.68	30.31	2.06

Condensing Temperature (°C)	Evaporating Temperature (°C)	Cooling Capacity (W)	Power Consumption (W)	Current Consumption (A)	Gas Flow Rate (kg/h)	Efficiency (W/W)
		±5%	±5%	±5%	±5%	±7%
<b>45°C</b>	10	3 435	1 216	5.70	82.59	2.82
	5	2 849	1 109	5.29	67.84	2.57
	0	2 338	1 010	4.88	55.21	2.31
	-5	1 891	916	4.48	44.34	2.07
	-10	1 496	820	4.10	34.89	1.82
	-15	1 143	720	3.72	26.51	1.59

Condensing Temperature (°C)	Evaporating Temperature (°C)	Cooling Capacity (W)	Power Consumption (W)	Current Consumption (A)	Gas Flow Rate (kg/h)	Efficiency (W/W)
		±5%	±5%	±5%	±5%	±7%
<b>55°C</b>	10	2 883	1 321	6.25	77.34	2.18
	5	2 369	1 194	5.72	62.90	1.98
	0	1 921	1 073	5.21	50.53	1.79
	-5	1 529	955	4.71	39.88	1.60
	-10	1 181	835	4.23	30.61	1.41

Test condition: EN 12900, Fan, Return Gas 20°C, Subcooling OK, Ambient: 35°C

### ASSEMBLY INSTRUCTION

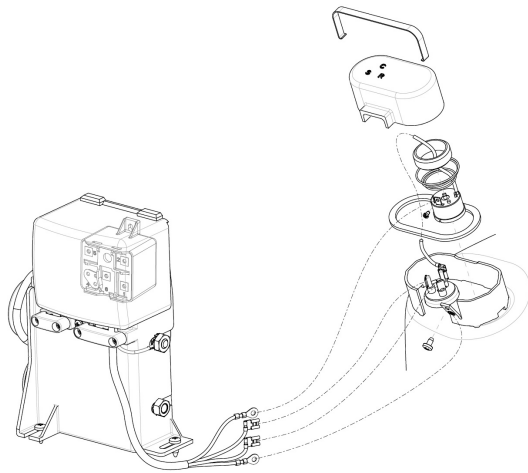

### WIRING DIAGRAM

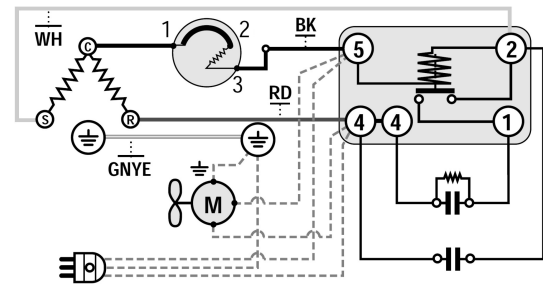

### OPERATING ENVELOPE

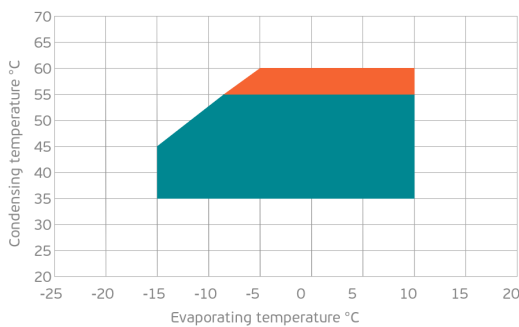

- Operating Condition
- Transient Condition
- Superheating

**NOTE:** usage of compressors outside of intended working range cannot make use of the warranty, or should be consulted with Technical support.

